

- 27' Eve Height
- 23' Eve Height
- All other lots shall have a 21' Eve Height
- Indicates Hangar Door Opening Direction

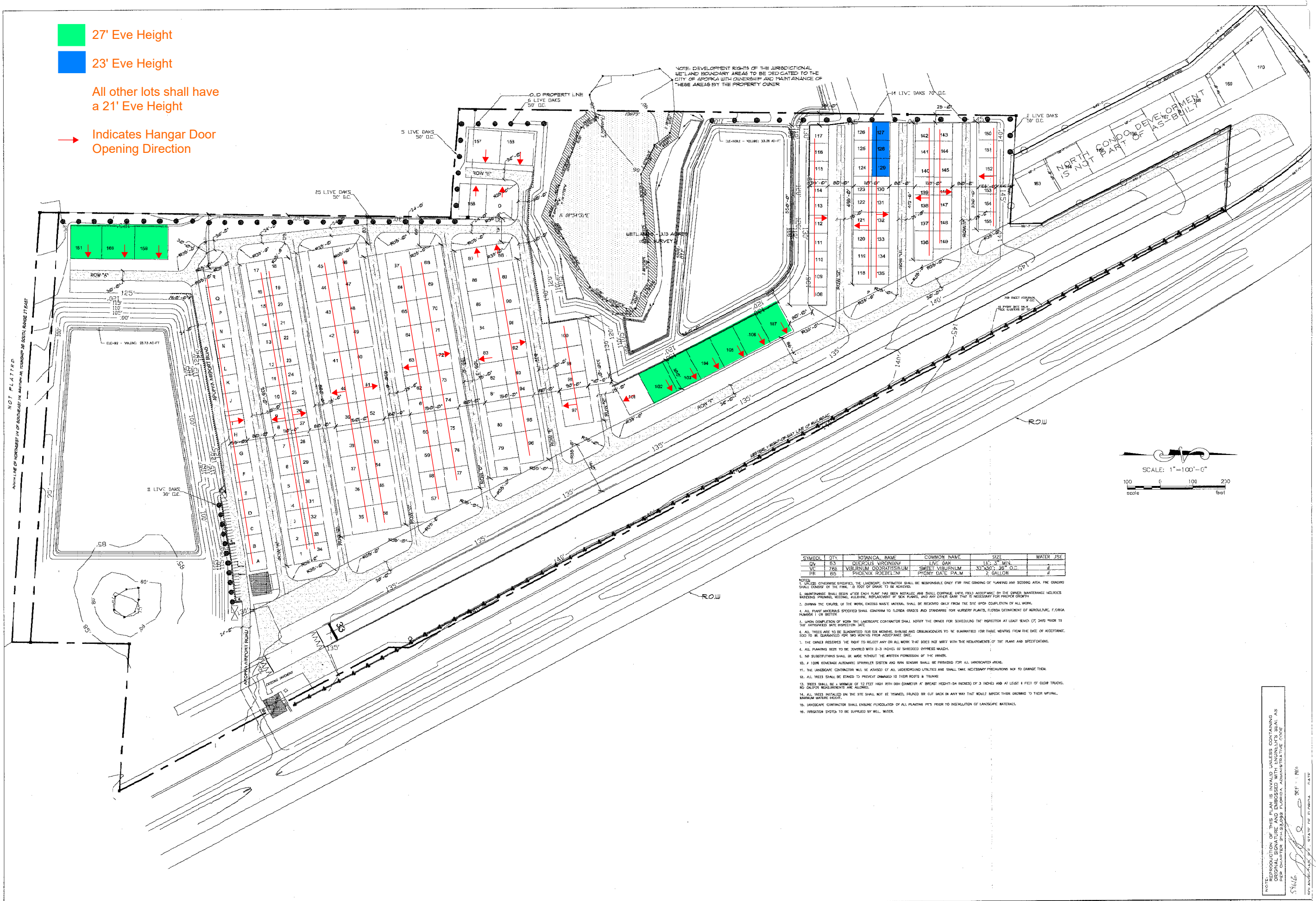

SYMBOL	QTY	SCIENTIFIC NAME	COMMON NAME	SIZE	WATER USE
Q1	83	QUERCUS VIRENOLUM	110' OAK	12" MIN	W
VB	785	VIBURNUM ODORATISSIMUM	SWEET VIBURNUM	30" DIA @ 18" D.C.	W
PE	65	PHOENIX ROEBELII	PHOENIX DATE PALM	2 GALLON	W

- NOTES:
- UNLESS OTHERWISE SPECIFIED, THE LANDSCAPE CONTRACTOR SHALL BE RESPONSIBLE ONLY FOR FINE GRADING OF PLANTING AND SEEDING AREA. FINE GRADING SHALL CONSIST OF THE FINAL 1/2 FOOT OF GRADE TO BE MAINTAINED.
 - MAINTENANCE SHALL BEGIN AFTER EACH SLAB HAS BEEN INSTALLED AND SHALL CONTINUE UNTIL FIELDS ACCEPTABLE BY THE OWNER. MAINTENANCE INCLUDES WEEDING, PRUNING, WEEDING, MULCHING, REPLACEMENT OF SOAK PLANTS, AND ANY OTHER CARE THAT IS NECESSARY FOR PROPER GROWTH.
 - DURING THE COURSE OF THE WORK, EXCESS WASTE MATERIAL SHALL BE REMOVED FROM THE SITE UPON COMPLETION OF ALL WORK.
 - ALL PLANT MATERIALS SPECIFIED SHALL CONFORM TO FLORIDA GRASS AND STAMENING FOR NURSERY PLANTS, FLORIDA DEPARTMENT OF AGRICULTURE, FLORIDA NUMBER 1 OR BETTER.
 - UPON COMPLETION OF WORK THE LANDSCAPE CONTRACTOR SHALL NOTIFY THE OWNER FOR SCHEDULING THE INSPECTOR AT LEAST SEVEN (7) DAYS PRIOR TO THE ANTICIPATED SITE INSPECTION DATE.
 - ALL TREES ARE TO BE GUARANTEED FOR SIX MONTHS. SHRUBS AND ORNAMENTALS TO BE GUARANTEED FOR THREE MONTHS FROM THE DATE OF ACCEPTANCE. 100% TO BE GUARANTEED FOR TWO MONTHS FROM ACCEPTANCE DATE.
 - THE OWNER RESERVES THE RIGHT TO SELECT ANY OR ALL WORK THAT DOES NOT MEET WITH THE REQUIREMENTS OF THE PLANS AND SPECIFICATIONS.
 - ALL PLANTING ARE TO BE SPACED WITH 3-3 INCHES OF SHARED-DIPRESS WALKER.
 - NO SUBSTITUTIONS SHALL BE MADE WITHOUT THE WRITTEN PERMISSION OF THE OWNER.
 - 1/4" TO 1/2" COARSE AUTOMATIC SPRINKLER SYSTEM AND RAIN SENSOR SHALL BE PROVIDED FOR ALL UNROOFED AREAS.
 - THE LANDSCAPE CONTRACTOR WILL BE ADVISED OF ALL UNDERGROUND UTILITIES AND SHALL TAKE NECESSARY PRECAUTIONS NOT TO DAMAGE THEM.
 - ALL TREES SHALL BE STAKED TO PREVENT DAMAGE TO THEIR ROOTS & TRUNKS.
 - TREES SHALL BE A MINIMUM OF 12 FEET HIGH WITH DBH (DIAMETER AT BREAST HEIGHT-54 INCHES) OF 3 INCHES AND AT LEAST 4 FEET OF CLEAR TRUNKS. NO COLOR REQUIREMENTS ARE ALLOWED.
 - ALL TREES INSTALLED ON THE SITE SHALL NOT BE TRIMMED, PRUNED OR CUT BACK IN ANY WAY THAT WOULD IMPED THEIR GROWING TO THEIR NATURAL MAXIMUM MATURE HEIGHT.
 - LANDSCAPE CONTRACTOR SHALL ENSURE PROTECTION OF ALL PLANTING PITS PRIOR TO INSTALLATION OF LANDSCAPE MATERIALS.
 - IRRIGATION SYSTEM TO BE SUPPLIED BY WELL WATER.

REVISIONS

△	REVISIONS TO FINAL DEVELOPMENT PLAN - JULY 28, 2005
△	
△	
△	

DAO CONSULTANTS, INC.
 CERTIFICATE OF AUTHORIZATION NO.: FL#5482
 1111 EAST MARKS STREET
 ORLANDO, FLORIDA 32803-4078
 PHONE: (407) 898-6672
 (407) 858-3778

ORLANDO COUNTRY AIRPORT
 CITY OF APOPKA, FL
 LANDSCAPE PLAN

DRAWN BY: KE
 CHECKED BY: DJ
 APPROVED BY: SCD
 ISSUE DATE: 05/1/2005
 PROJECT NO: 280423
 SHEET C-15 OF 15

NOTE: REPRODUCTION OF THIS PLAN IS INVALID UNLESS CONTAINING ORIGINAL ENGINEER'S SEAL AND SIGNATURE. THIS PLAN IS THE PROPERTY OF DAO CONSULTANTS, INC. AND IS NOT TO BE REPRODUCED OR TRANSMITTED IN ANY FORM OR BY ANY MEANS, ELECTRONIC OR MECHANICAL, INCLUDING PHOTOCOPYING, RECORDING, OR BY ANY INFORMATION STORAGE AND RETRIEVAL SYSTEM.

DATE: 05/1/2005